



LME-L SERIES

STANDARD LONG LINEAR BEARINGS

FEATURES

- Long type for increased rigidity
- European standard interchangeability
- Low friction
- Double rubber seal for corrosion resistance
- Easy mounting
- Low maintenance

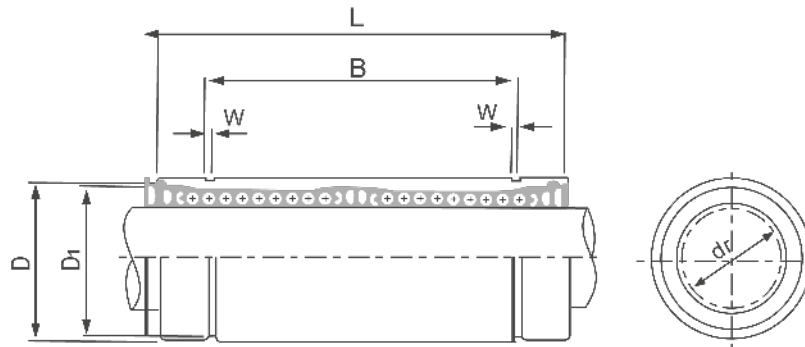

Type	Ball circuit	dr		D		L		B		D1	W	Eccentricity Excentricitate (max.) (μm)	Radial clearance (max.)		Weight (g)
		(mm)	(μm)	(mm)	(μm)	(mm)	(μm)	(mm)	(μm)				C	C0	
LME8LUU	4	8	+9	16	0-9	46		33		15,2	1,1		421	804	40
LME12LUU	4	12	+1	22	0	61	0	45,8	0	21	1,3	15	813	1570	80
LME16LUU	5	16	+11	26	-11	68	-300	49,8	-400	24,9	1,3		921	1780	115
LME20LUU	5	20	-1	32		80		61		30,3	1,6		1370	2740	180
LME25LUU	6	25	+13	40	0-13	112		82		37,5	1,85	17	1570	3140	430
LME30LUU	6	30	-2	47		123		104,2		44,5	1,85		2500	5490	615
LME40LUU	6	40		62	0	151	0-400	121,2	0-500	59	2,15		3430	8040	1400
LME50LUU	6	50	+16-4	75	-15	192		155,2		72	2,65	20	6080	15900	2320
LME60LUU	6	60		90	0/-20	209		170		86,5	3,15	25	7550	20000	3900